



To let

19 High Street, Budleigh Salterton, Devon, EX9 6LD

Prime High Street shop suitable for shop or office

Well presented accommodation

Approx: 550 sq ft / 51 sq m

100% Business Rates relief

1 parking space

Rent: £8,600 per annum

Viewing by prior appointment
with Damian Cook MRICS /
Vicky Bandyszewska

(01392) 202203

damian@sccexeter.co.uk

vicky@sccexeter.co.uk

strattoncrebercommercial.co.uk

Location

The property is situated in a prominent position within the heart of the town centre. The town is well-represented with some national retailers but mainly independent traders including the Co-op, Tesco Express, Lloyds Pharmacy together with Devon Air Ambulance and Oxfam.

The town also benefits from a number of coffee shops, cafés and restaurants.

Budleigh Salterton is a popular and sought after East Devon seaside town in an area of Outstanding Natural Beauty about 15 miles from Exeter.

There is a good resident population and surrounding catchment area and benefits from an influx of tourists in the summer months.

Description

The property comprises a self-contained ground floor lock up shop with front sales areas, separate office which could be incorporated in to sales, useful rear storage together with kitchen and w/c facilities.

Accommodation

The accommodation provides approximate dimensions and floor areas:-

Gross frontage: 17'6" (5.35m)

Ground floor

Sales area: 230 sq ft / 21.35 sq m

Office: 159 sq ft / 14.80 sq m

Store: 160 sq ft / 14.91 sq m

Kitchen/wc: Unmeasured

Net total: 550 sq ft / 51 sq m

Parking

There is one parking space to the rear of the property.

Lease Terms

The property is held by way of a lease for a term of 10 years from the 1st November 2015. The lease is drawn on a contributory full repairing basis with the tenant responsible for the internal repairs and decorations including the shop front and a fair proportion (1/3rd) of the external repairs and maintenance.

The landlord insures the property and recovers the appropriate fair proportion (1/3rd) of the annual premium from the tenant.

The passing rent is £8,600 per annum.

Energy Performance Certificate (EPC)

An EPC is available for this property and the rating is D/85.

Business Rates

Rateable value: £6,800.

Rates payable: Small business rates relief will be applicable to qualifying tenants for the full 100% rate.

VAT

VAT is not payable on the rent.

Viewing & Further information

Strictly by appointment through the sole agents:

Stratton Creber Commercial
20 Southernhay West, Exeter, EX1 1PR

Contact: Damian Cook MRICS
Vicky Bandyszewska
Tel: (01392) 202203
Email: damian@sccexeter.co.uk
vicky@sccexeter.co.uk



GROUND FLOOR
APPROX. FLOOR
AREA 56.9 SQ.M.
(612 SQ.FT.)

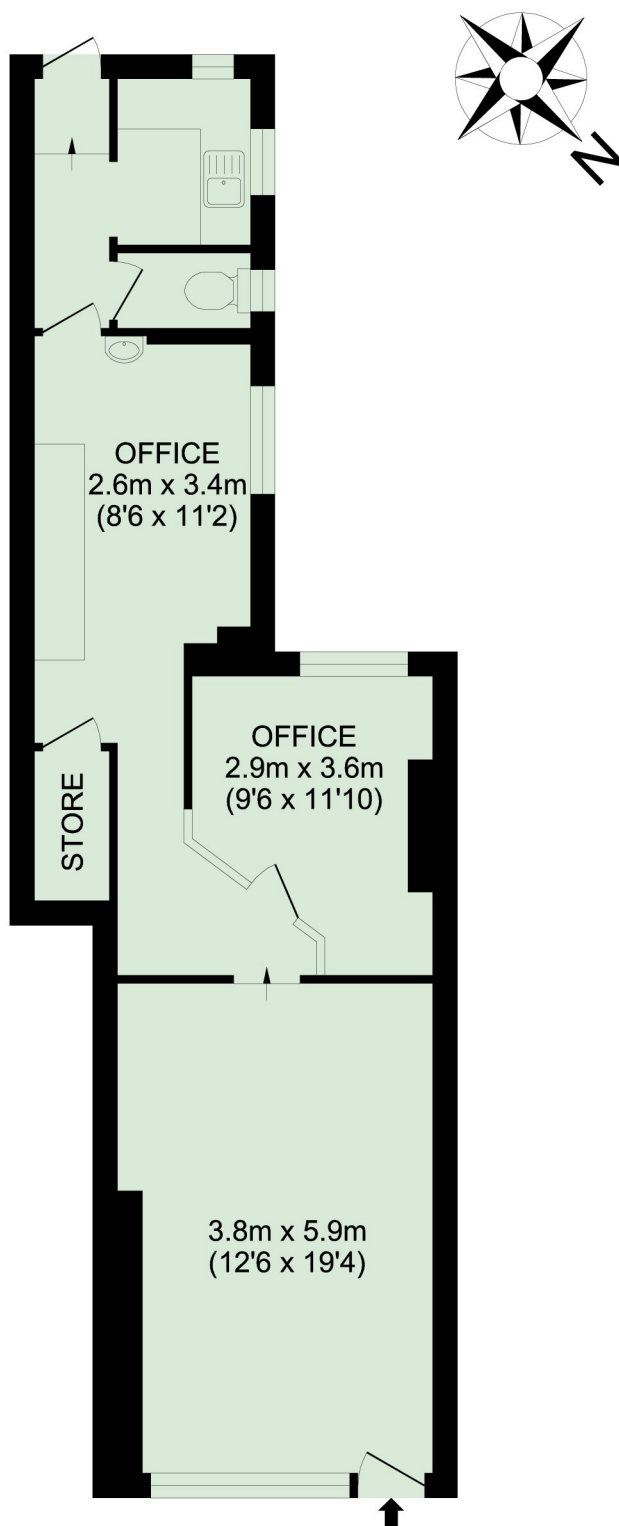

19 High Street Budleigh Salterton, EX9 6LD
Approximate internal area 56.9 Sq.M. - (612 Sq.Ft.)
For identification only - Not to scale.

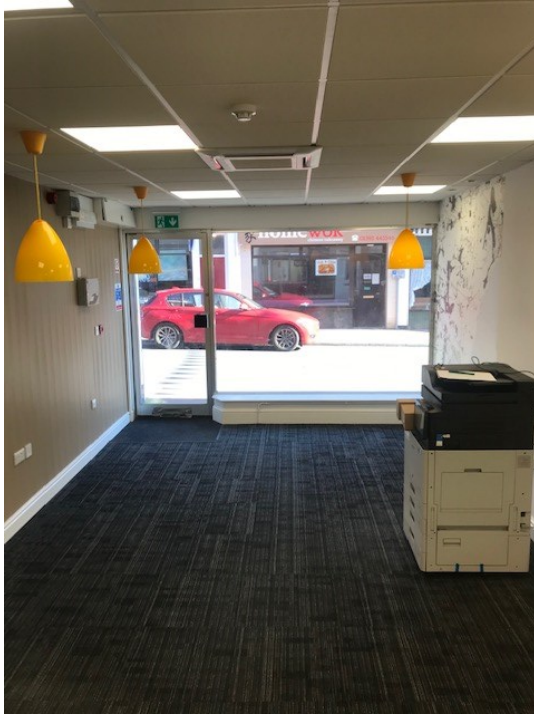

Exeter Office

20 Southernhay West, Exeter, EX1 1PR

T: (01392) 202203

F: (01392) 203091

E: info@sccexeter.co.uk

Stratton Creber Commercial for themselves and for the Vendors or Lessors of the property whose Agents they are, give notice that:

The particulars are set out as a general outline only for the guidance of intended purchasers or lessees, and do not constitute part of, an offer or contract;

All descriptions, dimensions, reference to condition and necessary permissions for use and occupation, and other details are given without responsibility and any intending purchasers or tenants should not rely on them as statements or representations of fact but must satisfy themselves by inspection or otherwise as to each of them;

No person in the employment of Stratton Creber Commercial has any authority to make or give any representation of warranty in relation to this property.